

USER MANUAL



Thank you for choosing Better Bathrooms.
Please read this manual before installing your product
and keep for future reference.

**better
bathrooms**

Solid surface Oval Basin- Opal OPALMW500 Solid Surface Deep Basin- Jasper JASPMW400



Solid Surface Pedestal Basin-Ruby RUBYMW40 Harley Traditional Oval Solid Surface Pedestal Basin
HAR660X900



Solid Surface Oval basin- Almas ALMAMW560 Solid Surface Gloss Round Basin- Jade JADEMW420



- **Single-person assembly**
- **Tools required**
- **We always recommend using professional tradespeople to install your product**

V2_10.09.25

Congratulations on your purchase

And welcome to our growing gang of savvy shoppers

We're on a mission to bring you extraordinary bathroom products, for less. From modern to traditional style ceramics, plus the gorgeous fixtures, fittings and furniture to match. So, you can fall in love with your space every single day.

As one of the UK's largest independent bathroom stores, we've received countless awards; including the National Business Awards UK, the Digital Entrepreneur Awards and being placed on The Sunday Times Fast Track 100.

We hope your new product goes above and beyond your expectations. However, should any problems occur, please:

- log in to your account and contact our customer services team via your self-serve portal – betterbathrooms.com/CustomerAccount/Login
- contact us via betterbathrooms.com/content/contact-us

Important information

- Please read these instructions thoroughly and retain for future reference
- Waste pipe are not supplied.

Contents

- Component Listing
- Technical Drawing
- Tools Required
- Installation Instructions
- Maintenance, Care & Cleaning

Component Listing

1. Basin

2.IM

3.Waste

4.Sanding sponges

Technical Drawing

Solid surface Oval Basin- Opal

OPALMW500

Solid Surface Oval basin- Almas

ALMAMW560

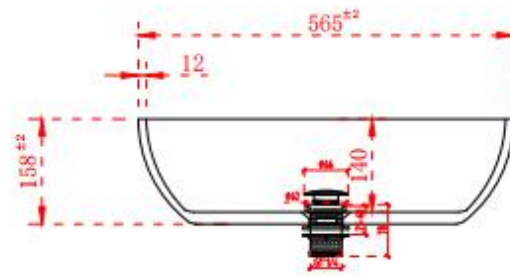
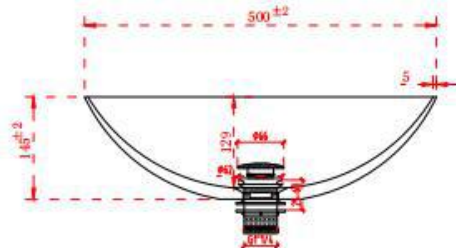
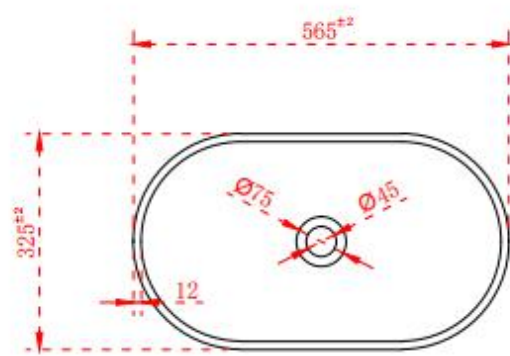
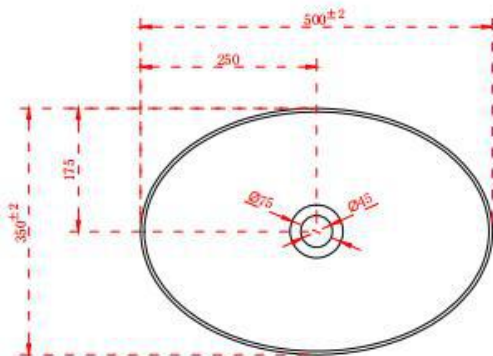

Solid Surface Deep Basin- Jasper JASPMW400

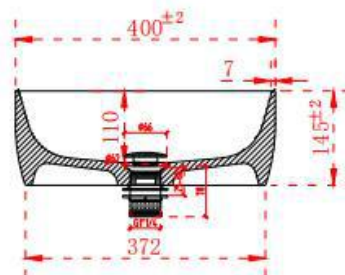
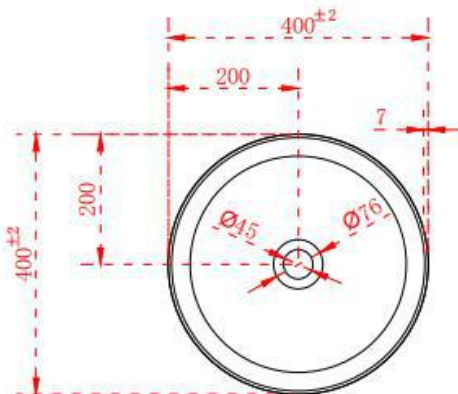

Solid Surface Gloss Round Basin and Waste- Jade JADEMW420

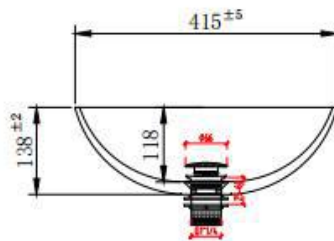
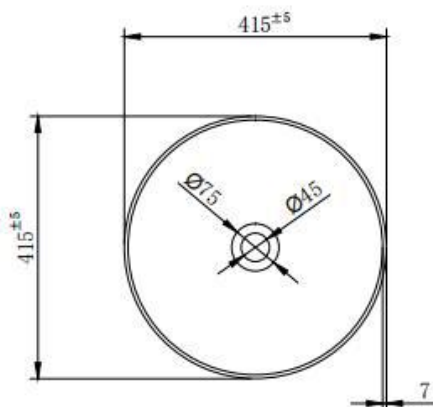

Solid Surface Pedestal Basin- Ruby RUBYMW40 Harley Traditional Oval Solid Surface Basin HAR660X900

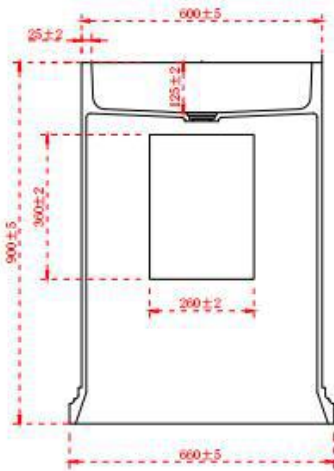
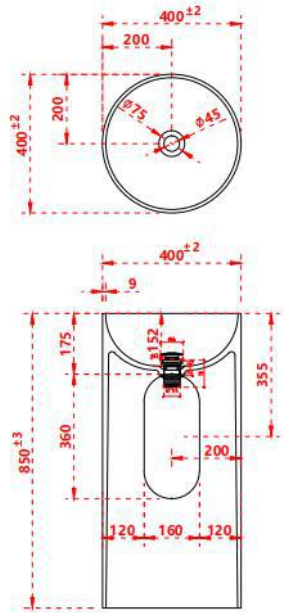

Tools Required

Silicone Adhesive

Installation Instructions

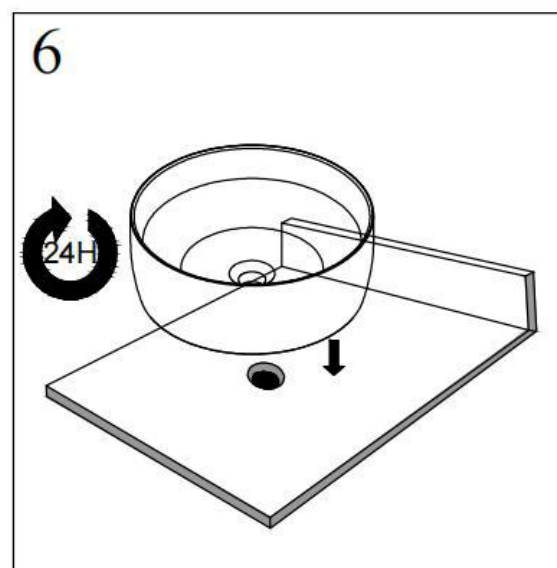
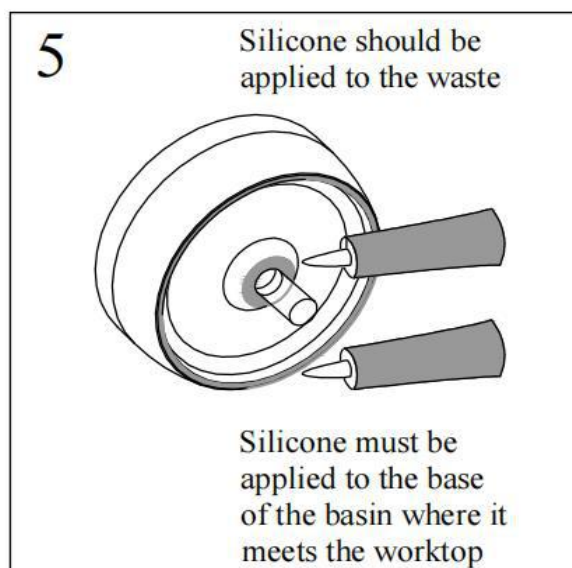
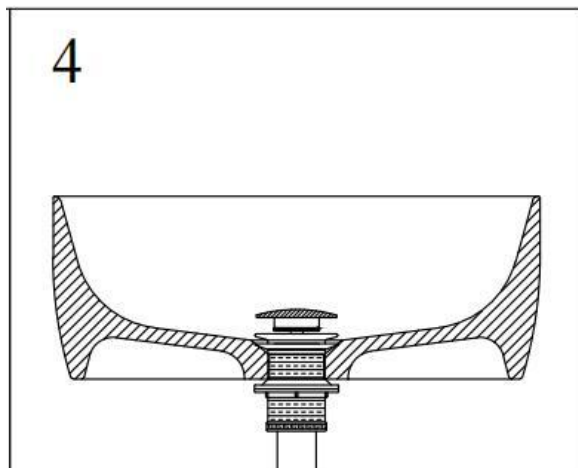
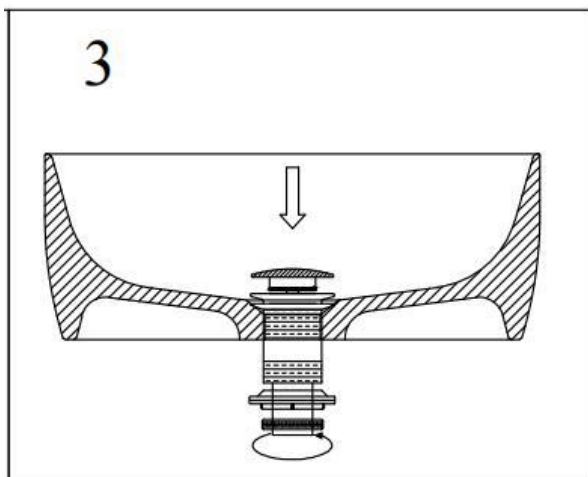
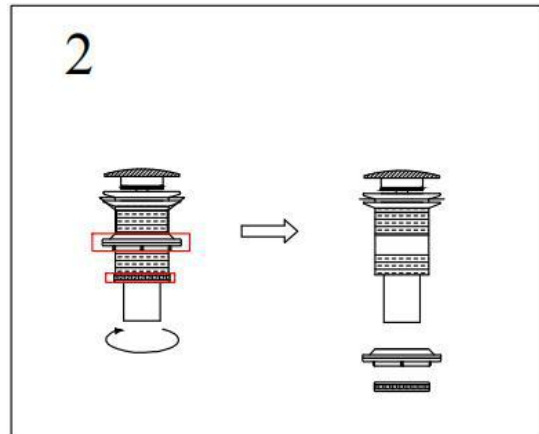
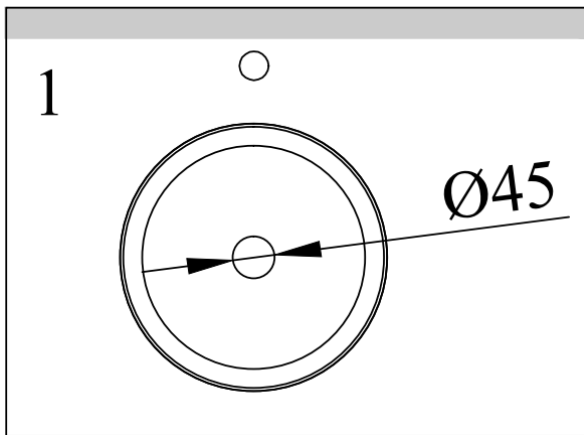

Maintenance, Care & Cleaning

Maintenance and Cleaning Instructions

1. For regular cleaning of both Glossy or Matte finishes, we recommend using widely available cleaning products. The Matte finish may occasionally require a mildly abrasive product.

2. Wipe surface with a soft cloth after each use.

To use a mild cleaning product.

For more stubborn stains, use a mildly abrasive cream cleanser.

3. Stubborn Stains, Scratches, and Damaged Surfaces

To repair/remove stubborn stains, scratches, smudges, and scuffs:

1) Use water to remove dirt and dust from the surface.

2) Use 800 grit sandpaper and sand lightly in small circular motions.

3) Follow with 1200 grit sandpaper (finer-grit) sanding lightly in small circular motions until smooth.

4) Dry with a towel.

5) For the Glossy finish, polish the surface with a cloth and a polishing compound for automobiles, such as 3M Extra Cut Compound.

Care Instructions

Wipe surface with a soft cloth after each use.

To use a mild cleaning product.

For more stubborn stains, use a mildly abrasive cream cleanser.

For more information

- visit betterbathrooms.com
- email customerservices@buyitdirect.co.uk
- call 0330 390 3062
- write to Trident Business Park, Neptune Way, Huddersfield, HD2 1UA

**better
bathrooms**

Part of the BuyItDirect Group